

**UNCOMMON
CARRY**



FOLDABLE PORTABLE
KEYBOARD

INSTRUCTION MANUAL

DISTRIBUTED BY
UNCOMMON CARRY

207-536-1174
www.uncommoncarry.com
10 W Point Ln., Suite 10-215,
Biddeford, ME 04005

TOP VIEW

MULTI-FUNCTION KEYS



BOTTOM VIEW

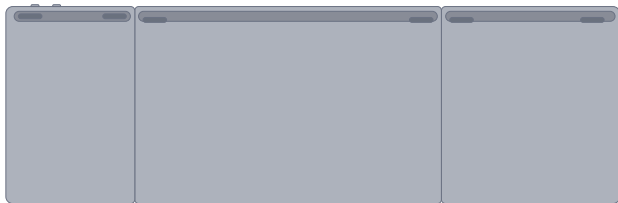

SIDE VIEW



01. POWER SWITCH

02. BLUETOOTH CONNECT

03. CHARGING / USB WIRED MODE

**COMPATIBLE
SYSTEM**

**WIN
IOS
ANDROID**

PRODUCT FEATURES

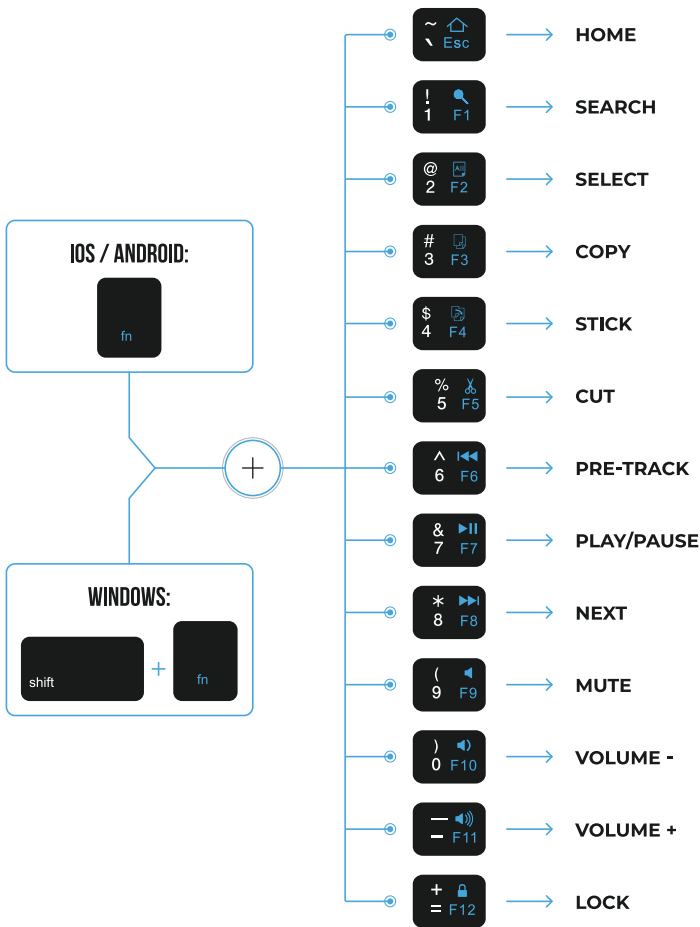

THREE-SYSTEM LANGUAGE

Switch to **iOS**:

CONTROL + SPACE KEY switch language

Switch to **Windows**:

ALT + SHIFT switch language

Switch to **Android**:

SHIFT + SPACE KEY switch language

TECHNICAL SPECIFICATIONS

Keyboard size (open):	11.9x3.8x0.3 inch (304.5x97.95x8 mm)
-----------------------	---

Touchpad size:	2.2x1.7 inch (54.8x44.8 mm)
----------------	------------------------------------

Touchpad working current:	< 11 mA
---------------------------	-------------------

Key working current:	< 5 mA
----------------------	------------------

Working distance:	32 ft (10 m)
-------------------	---------------------

Lithium battery capacity:	140 mAh
---------------------------	----------------

Working voltage:	3.7 V
------------------	--------------

Weight:	0.43 lbs (197.3 g)
---------	---------------------------

Standby current:	< 1.5 mA
------------------	--------------------

Sleep current:	< 60 μA
----------------	----------------------------------

Sleep time:	10 minutes
-------------	-------------------

Awaken way:	Press key
-------------	------------------

ANDROID CONNECTION INSTRUCTIONS

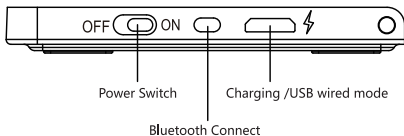

- 1 Turn on the power on the side of the keyboard (a blue light will become visible).

Press the Bluetooth connection button and the blue light will flash, the keyboard will enter match mode.

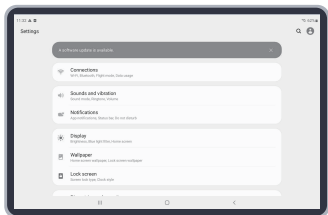

- 2 Open "Settings" and then click "Connect".

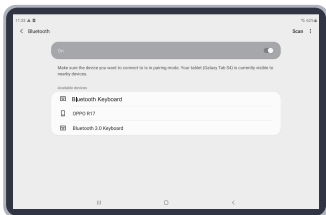

- 3 Turn on Bluetooth to search for the pair name.

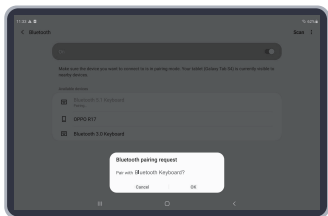

- 4 Click the pair name "Bluetooth Keyboard". Pair request is displayed, click OK.

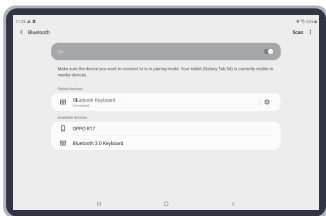

- 5 Connection Successful should display once the pairing is complete.

WINDOWS CONNECTION INSTRUCTIONS

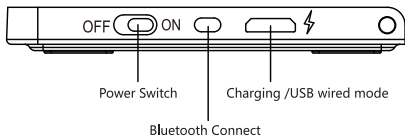

- 1 Turn on the power on the side of the keyboard (a blue light will become visible).

Press the Bluetooth connection button and the blue light will twinkle, the keyboard will enter match mode.

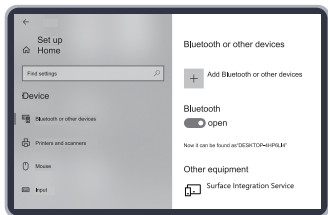

- 2 Open settings, turn on Bluetooth, click Add Bluetooth or other devices.

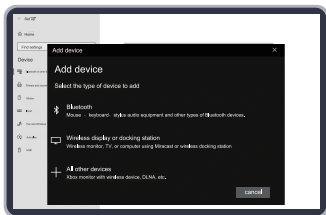

- 3 Select "Bluetooth" in the Add Device section to search.

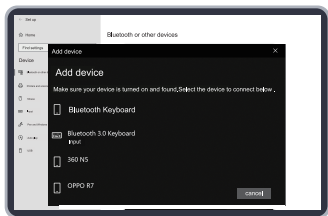

- 4 Click the pair name "Bluetooth Keyboard". Pair request is displayed, click OK.

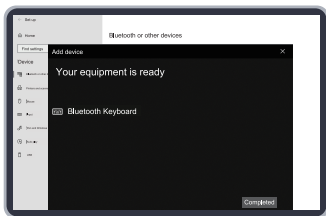

- 5 Connection Successful should display once the pairing is complete.

IOS CONNECTION INSTRUCTIONS

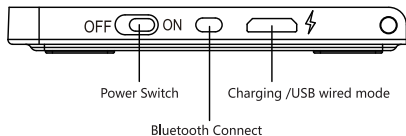

- 1 Turn on the power on the side of the keyboard (a blue light will become visible).

Press the Bluetooth connection button and the blue light will twinkle, the keyboard will enter match mode.

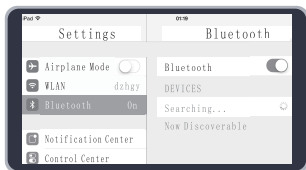

- 2 Under Settings, open "Bluetooth" and search for the pairing device.

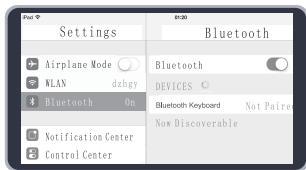

- 3 Click the pair name "Bluetooth Keyboard". Pair request is displayed, click OK.

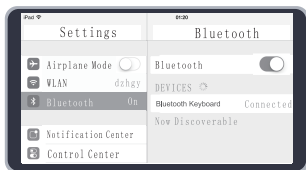

- 4 Connection Successful should display once the pairing is complete.

ANDROID

TOUCHPAD FUNCTION DESCRIPTION

(MUST BE SWITCHED TO ANDROID SYSTEM FUNCTION)



Tap
-The left of mouse button



Two-finger slides vertically/horizontally
-Mouse wheel



Two-finger tap
-Return



Drag
-Mouse cursor

STATUS DISPLAY LED

CONNECT:

Turn the power on, a blue light will appear. Press the connect button and a blue light will flash.

CHARGING:

Indicator light will be red, after it is fully charged, the light will turn off.

LOW VOLTAGE INDICATOR:

When the Volga is below 3.3V, a red light will flash.

TIP:

In order to prolong the lifespan of the battery, when the keyboard is not in use, please switch the power off.

WINDOWS

TOUCHPAD FUNCTION DESCRIPTION

(MUST BE SWITCHED TO ANDROID SYSTEM FUNCTION)



Tap
-The left of
mouse button

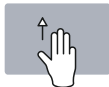

Three-finger slides up
-Open the browser
window



Two-finger tap
-The right of
mouse button

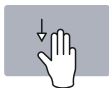

Three-finger slides down
-Go Home



Three-finger tap
-Search



Three-finger slides to
the right continuously
-Switch the active window



Four-finger tap
-Open the
(Action + Center)

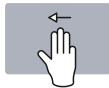

Three-finger slides to
the left continuously
-Switch the active window



Two-finger
separation / collapse
-Zoom in / out



Two-finger slides
vertically/horizontally
-Mouse wheel

TOUCHPAD FUNCTION DESCRIPTION

(MUST BE SWITCHED TO ANDROID SYSTEM FUNCTION)



Tap-Tap
(user-defined)



Three-finger slides up
-Open/hide the bottom
of the application bar
(Cmd + Alt + D)



Single finger double
tap and then drag
-Drag

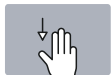

Three-finger slides down
-Open all the active windows
(Click the Homepage
button twice)



Two-finger tap
-Open menu
(user-defined)

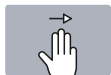

Three-finger slides right
-Active windows
(Cmd + Tab)



Three-finger tap
-Desktop
(user-defined)

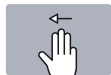

Three-finger slides left
-Active windows
(Cmd + Shift + Tab)

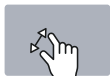

Two-finger
separation / collapse
-Zoom in / out

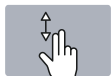

Two-finger
slides vertically
-Mouse wheel



Four-finger tap
-Regional screenshots
(Cmd + shift + 4)

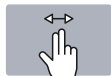

Two-finger slides
horizontally
-Slide the desktop
left and right



Drag
-Mouse cursor

FAQ

THE TABLET IS NOT CONNECTING TO THE BT KEYBOARD?

- A** First, check if the BT Keyboard is in the “match code state”, then open the tablet Bluetooth setting.
- B** Make sure that the BT Keyboard battery is charged, low battery could prevent connection.

THE KEYBOARD INDICATOR LIGHT IS FLASHING WHEN IN USE?

- The flashing light indicates low battery, please charge the device.

THE KEYBOARD HAS ABRUPTLY DISCONNECTED?

- If the bluetooth keyboard is left on for an extended period of time, the device will enter sleep mode in order to preserve power. Press any key to resume the connection.

KEYBOARD MAINTENANCE

- Please keep the keyboard away from liquid. Keep the keyboard away from humid environments.
- Please do not expose the keyboard to extreme temperatures.
- Keep away from flames or hot surfaces.
- Avoid cleaning with sharp objects.