

SHARPER IMAGE®

POP-UP 6-FT. WHITE FLOCKED CHRISTMAS TREE

Item No. 207108

User Guide

Thank you for purchasing the Sharper Image Pop-Up 6-Ft. White Flocked Christmas Tree. Please take a moment to read this guide and store it for future reference.

FEATURES

- 200ct warm white LED lights
- Lighting mode: Steady on
- Indoor use only

COMPONENTS

- 19pcs Matte Silver and 19 pcs Silver Baubles
- 12pcs Flocked Snowflakes
- 2 pcs Metal Poles, 1 pc Metal Base, 1 pc Tree Body
- Folds flat for storage

ASSEMBLY INSTRUCTIONS

- Carefully remove all components from the box and choose a firm, flat surface where air vents will not be blocked or covered to assemble the tree
- Make sure the main plug and adapter is not connected to the socket when assembling products

Step 1: Connect the metal poles one by one, and insert into the base

Step 2: Drape the tree over the top of the connected metal poles carefully

Step 3: Connect power cord with adapter properly, and plug the adapter into an AC power outlet

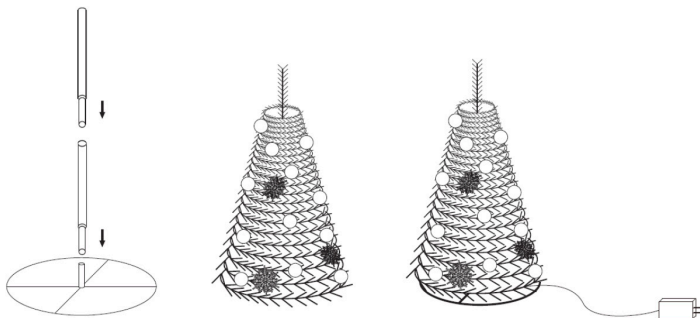

TROUBLESHOOTING

- If the lights stop working check for loose wires, ensure the wires are properly connected with adapter
- Ensure the power outlet is working normally
- Ensure the adapter plug is inserted into the power outlet properly
- Plug the adapter into another power outlet on a different circuit
- Contact Sharper Image customer service for assistance if the steps above don't fix the problem

WARNINGS

- This is an electric product, not a toy
- To avoid risk of fire, burns, personal injury and electric shock, this product should not be played with or placed where small children can reach it
- Do not use this product for anything other than its intended use
- Do not use or attach any additional electric lights or light strings to this decoration
- This seasonal-use product is not intended for permanent installation or use
- Do not mount or place this decoration near gas or electric heaters, fireplaces, candles or other similar sources of heat

CAUTION

- This product is suitable for indoor use only
- The light set is constructed with non-replaceable LED bulbs
- Keep away from any source of heat or flame
- Unplug this product at night or when unattended

MAINTENANCE

- Before use or reuse, inspect the product carefully
- Discard the product if there are cuts, cords damaged or wire insulation frayed, copper wire exposed, or lamps are cracked
- When not in use, store the product neatly in a cool, dry location away from sunlight

WARRANTY AND CUSTOMER SERVICE

Sharper Image branded items purchased from SharperImage.com include a 1-year limited replacement warranty. If you have any questions not covered in this guide, please call our Customer Service department at 1 (877) 210-3449. Customer Service agents are available Monday through Friday, 9:00 a.m. to 6:00 p.m. ET.

SHARPER IMAGE®

The SHARPER IMAGE® name and logo are registered trademarks.

©Sharper Image. All Rights Reserved.