

SHARPER IMAGE®

CORDLESS AIR COMPRESSOR

Item No. 206888

User Guide



Thank you for purchasing the Sharper Image Cordless Air Compressor. Please take a moment to read this guide and store it for future reference.

IDENTIFICATION OF PARTS

1. The unit
2. LCD screen
3. Start and Pressure button
4. Charging Port
5. LED Button
6. Inflate Button
7. LED Light
8. Air Hose
9. Balls Pin
10. Balloon Pin
11. French Valve
12. Charging Adapter

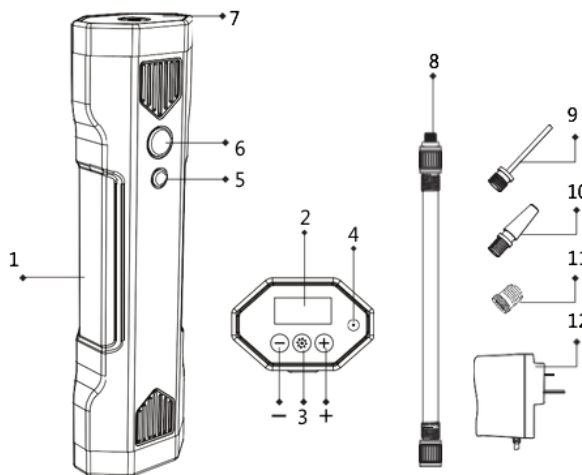

The product is suitable for use in automobiles, motorcycles, bicycles, electric cars and small inflatable toys. It can also be used as a tire pressure gauge.

HOW TO USE

- How to use Cordless: Connect one end of the pipe with the air pump and screw the other end into the tire valve core. To use the French valve core, the adapter must be added.
- How to use corded: Connect the car cigarette lighter line into the 12V spot [the lithium battery can be charged at the same time]. Connect one end of the gas pipe to the air pump and the other end to the tire valve core. To use the French valve core, connect the switch to the nozzle.
- To enhance the product performance and extend the battery life of the car, start the car engine before you use the unit.
- To activate the LCD display press the “⊕” key. It will activate the power supply and set the air pressure.
- To cycle through options press the “⊕” key and select PSI, BAR or KG/CM2. The screen will display the actual air pressure.
- “+” and “-” are the preset keys of pressure. Short press for slow pressure and long press for fast pressure. After selecting, the appropriate pressure value will be set and will flash for 4 seconds. To automatically set [press the “⊕” button immediately].
- When the inflation reaches the set point, the intelligent control air pump will automatically stop.
- After inflation, one end of the trachea will rapidly rotate out of the valve core, and the other end will turn out from the main engine.

INSTALLATION

- Connect the air hose/trachea to the electric inflator.

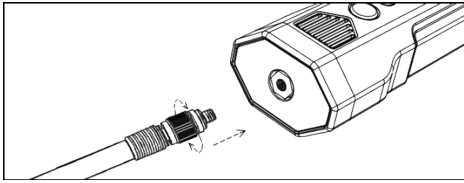

- Connect the trachea to the car tire.

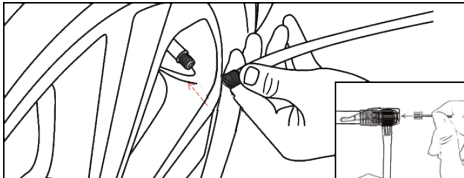

- Tighten the connection between the air hose and the tire.

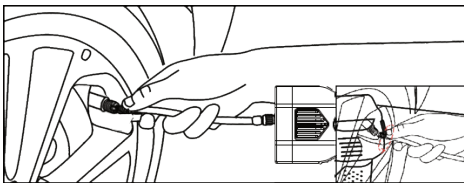

HOW TO CHARGE

- Connect the charging adapter to the unit and plug into an AC outlet or to your car's cigarette outlet.
- Press the charging button to charge the unit.
- Charge time is approximately 4-5 hours.

Note: The LED light can be used alone as a flashlight. Simply press the LED light button once to turn on and again to turn off.

SPECIFICATIONS

Product item:	206888
Product name:	Cordless Air Compressor
Input voltage:	Charging adapter DC 14V/500mA
Working Voltage:	DC 12V
Rate of work:	≤72W
Battery capacity:	2000mAh
Inflation efficiency:	185/70R14 6mins
The maximum inflation pressure:	120PSI
Pressure unit:	PSI, BAR, KGF/CM ²
The length of hose:	215mm±10mm
Car Charger Power Cord:	3m
Operating Temperature:	0°C-60°C
Product Size:	2.6"L x 1.7"W x 9"H
The Weight of Product:	1.3 lbs.

Pressure units	Lock-out state	Set state
PSI	0.0	32.5
BAR	0.00	2.40
KG/CM ²	0.00	2.45

WARNINGS

- Keep this unit away from children. Don't insert the hose to the mouth, ears and eyes.
- Don't use the pump close to flammable and combustible areas such as gas stations.
- This unit generates heat when in use uninterruptedly for 10 minutes. Let the pump stop at least 15 minutes before storing away.
- If the unit generates abnormal sound or the temperature is too high, stop using it for at least 15 minutes. **Caution:** *The unit will be hot when you tidy the hose.*
- Don't use the pump where there is water.
- If you don't use the unit for a long time store it in a dry area. Charge it once every 6 months if stored away for an extended time.
- Make sure the unit is fully charged before using.

WARRANTY AND CUSTOMER SERVICE

Sharper Image branded items purchased from SharperImage.com include a 1-year limited replacement warranty. If you have any questions not covered in this guide, please call our Customer Service department at 1 (877) 210-3449. Customer Service agents are available Monday through Friday, 9:00 a.m. to 6:00 p.m. ET.

SHARPER IMAGE®

The SHARPER IMAGE® name and logo are registered trademarks.

©Sharper Image. All Rights Reserved.