



Carina Bluetooth Speaker Duo

User Guide

SBT615-2

In the box



Bluetooth Speakers

User Guide

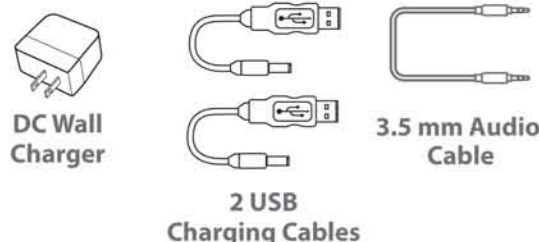

DC Wall Charger

3.5 mm Audio Cable

2 USB Charging Cables

Charging the Bluetooth Speakers

1. Plug the pin of one of the USB Charging Cables into the DC 5V charging port on the back of one of the speakers.
2. Plug the USB end of the USB Charging Cable into an available USB port on your computer.
3. Plug the pin of the 2nd USB charging cable into the DC 5V charging port on the back of the other speaker.
4. Plug the USB end of the 2nd USB charging cable into the USB port on the DC Wall Charger (included).
5. Plug the DC Wall Charger into a wall socket or power strip.
6. The LED charging indicator light on the back of the speakers will light up RED when charging. They will shut OFF when the speakers are fully charged.

NOTE: The speakers come with one DC wall charger. If you have 2 available USB ports on your computer, you can charge both speakers via these USB ports or use the DC Wall Charger one speaker at a time.

Make sure you charge the speakers for at least 5 hours before using them for the first time.

Location of Controls

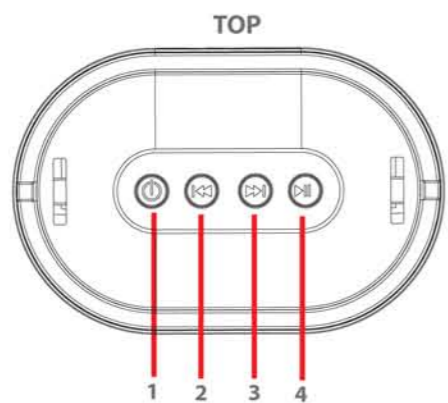

1. **[⏻] button:** Power ON/OFF
2. **[⏮] button:** • quick press for previous song
• long press to decrease volume
3. **[⏭] button:** • quick press for next song
• long press to increase volume
4. **[⏸] button:** • quick press to pause/play music
• long press for Bluetooth pairing
• Bluetooth indicator light

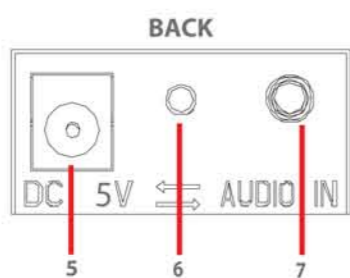

5. DC 5V charging port
6. LED indicator light
7. AUDIO IN jack

Pairing both speakers to one Bluetooth enabled device

NOTE: When pairing both speakers to one device, it does not matter which speaker you start with. Whichever one you turn on first will be referred to as **Speaker A**. The second one you turn on will be referred to as **Speaker B**.

1. On the first speaker, press and HOLD the [⏻] button for three seconds and release. You will hear a few beeps and the [⏸] button will begin to flash BLUE quickly. **Speaker A** is now in pairing mode.
2. On the second speaker, press and HOLD the [⏻] button for three seconds and release. You will hear a few beeps and the [⏸] button will begin to flash BLUE quickly. **Speaker B** is now in pairing mode.
3. At the same time, press and HOLD the [⏻] button on **Speaker A** and the [⏸] button on **Speaker B** for two full seconds or until you hear a beep.
 - **Speaker A:** the [⏸] button will flash BLUE quickly.
 - **Speaker B:** the [⏸] button will stay a steady RED.
4. Both speakers are now connected and they are in Pairing Mode together.

NOTE: if you hold both buttons too long the speakers will power OFF. If this happens turn them ON again and retry step 3.

5. Set your mobile phone or other Bluetooth enabled device to search/scan for Bluetooth Devices.

On an iPhone
• Go to SETTINGS > BLUETOOTH (Make sure Bluetooth is turned ON)

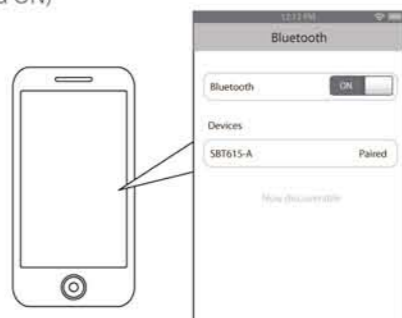

On a BlackBerry
• Go to SETTINGS/OPTIONS > BLUETOOTH
• Enable BLUETOOTH

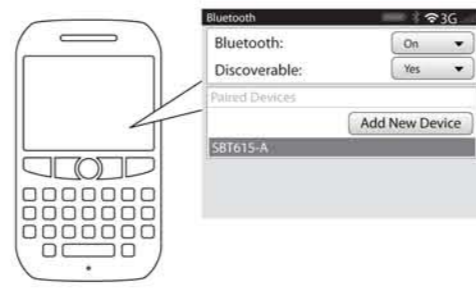

On an Android Phone
• Go to SETTINGS > BLUETOOTH > MENU > Search for devices (Make sure Bluetooth is turned ON)

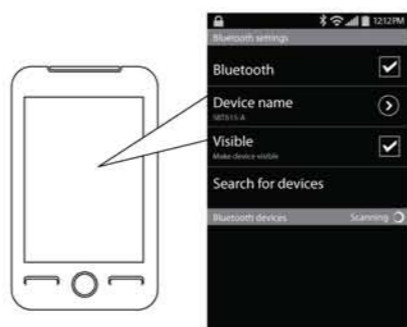

On other Cell Phones/Devices
• Review the instruction manual that came with your phone/device.

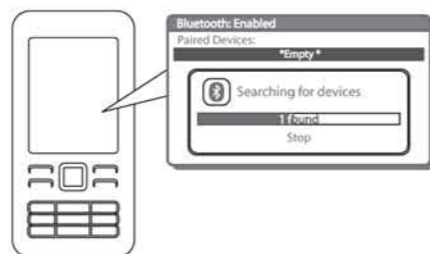

6. When the Bluetooth enabled device finds the Speakers, select "SBT615-A" from the list of found devices.
7. If required, enter the password "0000". Select OK or Yes to pair the Speakers.
8. After a successful registration, the Speakers will beep twice
 - **Speaker A:** the [⏸] button will stay a steady BLUE
 - **Speaker B:** the [⏸] button will stay a steady RED

NOTE: When you power OFF the speakers (see "Using your Bluetooth Speakers") they will disconnect from your Bluetooth device. When you turn them on again, select "SBT615-A" from your device's Bluetooth list to reconnect them again.

The screenshots above are typical of many Bluetooth enabled devices in the market today, and are used to assist in the explanation of the pairing process. Your Bluetooth enabled device's interface and interaction with the Bluetooth Speakers may slightly differ from the illustrations above.

Pairing the speakers separately to two Bluetooth enabled devices

- Pairing the first speaker to a Bluetooth device**
1. Make sure both speakers are powered OFF.
 2. Turn ON one speaker only (press and HOLD the [⏻] button for 3 seconds or until you hear beeps).
 3. The [⏸] button will flash BLUE. The speaker is now in pairing mode.
 4. Set your mobile phone or other Bluetooth enabled device to search/scan for Bluetooth Devices.
 5. When the Bluetooth enabled device finds the speaker, select "SBT615-A" from the list of found devices.
 6. If required, enter the password "0000". Select OK or Yes to pair the Speakers.
 7. After a successful registration, the Speaker will beep and the [⏸] button will remain a steady BLUE.
 8. **Speaker A** is now connected to your first Bluetooth device.

Pairing the second speaker to a different Bluetooth device

1. Turn on the second speaker (press and HOLD the [⏻] button for 3 seconds or until you hear beeps).
2. The [⏸] button will flash BLUE. The speaker is now in pairing mode.
3. Set your mobile phone or other Bluetooth enabled device to search/scan for Bluetooth Devices.
4. When the Bluetooth enabled device finds the speaker, select "SBT615-B" from the list of found devices.
5. If required, enter the password "0000". Select OK or Yes to pair the Speakers.
6. After a successful registration, the second speaker will beep and the [⏸] button will remain a steady BLUE.
7. **Speaker B** is now connected to your second Bluetooth device.

Using your Bluetooth Speakers

Using the speakers together (both paired to one device)

NOTE: This is when you have already paired both speakers to one device.

Powering ON

1. Long press the [⏻] button on both speakers for 3 seconds or until you hear the beeps. You can do this separately or at the same time.
 - **Speaker A:** the [⏸] button will flash BLUE quickly.
 - **Speaker B:** the [⏸] button will stay a steady RED.
2. Select "SBT615-A" from your devices Bluetooth list to reconnect them again.

Powering OFF

1. Press the [⏻] button on one of the speakers for 3 seconds or until you hear the beeps. The speakers will BOTH turn OFF.

Adjusting the volume

1. Press and HOLD the [⏮] button on either speaker to decrease the volume on both speakers.
2. Press and HOLD the [⏭] button on either speaker to increase the volume on both speakers.

You can also adjust the volume from your connected device's volume control.

Using the speakers separately (each speaker connected to a different device)

NOTE: This is when you have already paired both speakers to two different devices or you only want to use one speaker.

Powering ON

1. Long press the [⏻] button on the speaker for 3 seconds or until you hear the beeps.
2. The [⏸] button will flash BLUE quickly.
3. Depending on which speaker you are turning ON, select "SBT615-A" or "SBT615-B" from your device's Bluetooth list to reconnect again.

Powering OFF

1. Long press the [⏻] button on the speaker for 3 seconds or until you hear the beeps. The speaker will power OFF.

Adjusting the volume

1. Press and HOLD the [⏮] button on the speaker to decrease the volume.
2. Press and HOLD the [⏭] button on the speaker to increase the volume.

You can also adjust the volume from your connected device's volume control.

Playing Music

To enjoy wireless music on your Bluetooth Speakers, make sure you are connected to a Bluetooth enabled device. Once connected, press PLAY on your Bluetooth device. Once playback has begun, you can control the music from the Speaker(s) controls.

NOTE: If both speakers are connected to one device, you can control both speakers' music controls from one of the speakers. For example, pressing [⏮] on one speaker will raise the volume of both speakers.

Play/Pause

- Quick press the [⏸] button to pause the music.
- To resume music playback, quick press the [⏸] button again.

Skipping Songs

- Quick press the [⏭] button to skip to the next song.
- Quick press the [⏮] button skip to the previous song.

Adjusting the volume

1. Press and HOLD the [⏮] button on the speaker to decrease the volume.
2. Press and HOLD the [⏭] button on the speaker to increase the volume.

You can also adjust the volume from your connected device's volume control.

Using as wired speakers

1. Turn ON one of the speakers.
2. Connect one end of the 3.5mm Audio cable to the AUDIO IN jack on the back of the speaker, and the other end of the cable to an external device's headphone jack (smartphone, tablet, MP3 player).
3. Use the controls on your connected device to control music playback and volume.

NOTE: On some devices, if the volume is too low you can raise the volume on your device as well as the speaker.

Connecting the audio cable will not override Bluetooth mode. Be sure to turn Bluetooth off or unpair the device before using the AUDIO IN feature. Only 1 speaker may be used if using this feature.

Troubleshooting tips

I can pair the Bluetooth Speakers with my Bluetooth enabled device, but I cannot hear any music.

1. Make sure your Bluetooth device supports A2DP profile.
2. Turn up the volume on your Bluetooth device.
3. You may have to unpair the speaker, then re-pair to your device.

I cannot get the Bluetooth Speakers into Pairing mode.

1. Make sure the Bluetooth Speakers are turned OFF before beginning the pairing process.
2. A tone will sound, indicating that the speakers are in pairing mode, and the LED Bluetooth indicator light will flash BLUE quickly.
3. The speakers are now in pairing mode.

My Bluetooth device is not able to pair with the Bluetooth Speakers.

1. Make sure the Bluetooth Speakers are turned OFF before beginning the pairing process.
2. Keep your Bluetooth Speakers and Bluetooth enabled device within 3 feet of each other during the pairing process.
3. Check that YOUR device's Bluetooth feature is turned ON.
4. Try repeating the pairing process: see "Pairing both speakers to one Bluetooth enabled device" or "Pairing the speakers separately to two Bluetooth enabled devices."

Legal information

FCC Part 15:

This equipment has been tested and found to comply with the requirements for a Class B digital device under Part 15 of the Federal Communications Commission (FCC) rules. These requirements are intended to provide reasonable protection against harmful interference in a residential installation. This equipment generates, uses and can radiate radio frequency energy and, if not installed and used in accordance with the instructions, may cause harmful interference to radio communications. However, there is no guarantee that interference will not occur in a particular installation. If this equipment does cause harmful interference to radio or television reception, which can be determined by turning the equipment off and on, the user is encouraged to try to correct the interference by one or more of the following measures:

- Re-orient or relocate the receiving antenna.
- Increase the separation between the equipment and receiver.
- Connect the equipment into an outlet on a circuit different from that to which the receiver is connected.
- Consult the dealer or an experienced radio/TV technician for help.

Do not attempt to repair or modify this equipment.

Warning: Changes or modifications to this equipment not expressly approved by the party responsible for compliance could void the user's authority to operate the equipment. This device complies with Part 15 of the FCC Rules. Operation is subject to the following two conditions:

- (1) this device may not cause harmful interference, and
- (2) this device must accept any interference received, including interference that may cause undesired operation."

Limited warranty

90 Days Limited Warranty

In the unlikely event that this product is defective, or does not perform properly, you may within ninety (90) days from your original date of purchase return it to the authorized service center for repair or exchange.

TO OBTAIN WARRANTY SERVICE:

- Provide proof of the date of purchase within the package (Dated bill of sale).
- Prepay all shipping costs to the authorized service center, and remember to insure your return.
- Include a return shipping address (no P.O. Boxes), a telephone contact number, and the defective unit within the package.
- Describe the defect or reason you are returning the product.

Your product will be repaired or replaced, at our option, for the same or similar model of equal value if examination by the service center determines this product is defective. Products received damaged as a result of shipping will require you to file a claim with the carrier.

The shipping address of the authorized service center is:

Southern Telecom, Inc.
Attention: Customer Service (2nd Floor)
14-C 53rd Street
Brooklyn, NY 11232

Warranty service not provided

This warranty does not cover damage resulting from accident, misuse, abuse, improper installation or operation, lack of reasonable care, and unauthorized modification. This warranty is voided in the event any unauthorized person opens, alters or repairs this product. All products being returned to the authorized service center for repair must be suitably packaged.

Limitation of Warranty:

• THE WARRANTY STATED ABOVE IS THE ONLY WARRANTY APPLICABLE TO THIS PRODUCT. ALL OTHER WARRANTIES, EXPRESS OR IMPLIED (INCLUDING ALL IMPLIED WARRANTIES OF MERCHANTABILITY OR FITNESS FOR A PARTICULAR PURPOSE) ARE HEREBY DISCLAIMED. NO VERBAL OR WRITTEN INFORMATION GIVEN BY AIT, INC. ITS AGENTS, OR EMPLOYEES SHALL CREATE A WARRANTY OR IN ANY WAY INCREASE THE SCOPE OF THIS WARRANTY.

• REPAIR OR REPLACEMENT AS PROVIDED UNDER THIS WARRANTY IS THE EXCLUSIVE REMEDY OF THE CONSUMER. AIT, INC. SHALL NOT BE LIABLE FOR INCIDENTAL OR CONSEQUENTIAL DAMAGES RESULTING FROM THE USE OF THIS PRODUCT OR ARISING OUT OF ANY BREACH OF ANY EXPRESS OR IMPLIED WARRANTY ON THIS PRODUCT. THIS DISCLAIMER OF WARRANTIES AND LIMITED WARRANTY ARE GOVERNED BY THE LAWS OF THE STATE OF NEW YORK. EXCEPT TO THE EXTENT PROHIBITED BY APPLICABLE LAW, ANY IMPLIED WARRANTY OF MERCHANTABILITY OR FITNESS FOR A PARTICULAR PURPOSE ON THIS PRODUCT IS LIMITED TO THE APPLICABLE WARRANTY PERIOD SET FORTH ABOVE.

Some states do not allow the exclusion nor limitation of incidental or consequential damages, or limitations on how long an implied warranty lasts so the above limitations on exclusions may not apply to you. This warranty gives you specific legal rights, and you also may have other rights that vary from state to state.

Should you have any questions or problems concerning this product, please contact our customer service department at:

Customer Support:
Phone: 1-877-768-8481
Monday-Friday 8AM-10PM(EST)

www.southerntelecom.com
Click on "Product Support"